

Steely entrance panel general characteristics

Flush mounting boxes

Zinc-plated metal boxes for the Steely and Patavium series with 2, 3 and 4 modules. For the Steely series, in the 2-module version the boxes can be combined both horizontally and vertically, using the brackets supplied as standard with the boxes. It is supplied as standard with an anti-mortar cover for protection during installation.

Frame

The zinc-plated metal frame supplied with the Steely cover plate is used for fixing the electronic units to the flush mounting box.

Connection terminal block

The terminal block ensures simple and practical connection of the electronic unit to the system with its quick coupling connector.



Cover plates

Audio and audio/video cover plates with 2, 3 and 4 modules in 4 mm thick brushed 316L stainless steel. They are fixed directly to the flush mounting box with special Torx screws.



Electronic units

Audio, audio/video electronic units with colour camera. In version with buttons or version with display and alphanumeric keypad, with steel buttons. Fitted with backlighting system white-light LEDs. The button versions can be expanded using the 12TS.B unit.



Steely entrance panels

Electronic units

Audio and video electronic units combinable with Steely series to make up entrance panels. Supplied with a standard configuration, they can be customized to suit the particular system. The electronic unit can be programmed from the unit itself, or using programmer 950C, or alternatively, the PC software application SaveProg with interface 692I or 692I/U.

Regulatory compliance

EMC directive

Standards EN 60065, EN 61000-6-1, EN 61000-6-3 and EN 60118-4

13A4.B and 13A7.B - Main characteristics

- Electronic unit with alphanumeric display and white backlighting.
- Alphanumeric keypad for making calls, exploring the electronic contacts list, and configuring basic and advanced parameters of the electronic unit.
- Indication of "Engaged - Please Wait", "Do not disturb" message and operating steps on panel display.
- Electronic contacts list with memory capacity for up to 1000 users (2 names of 15 characters each, per user).
- Automatic configuration of indoor station addresses.
- Audio external unit with sound balance control provided and internal and external volume levels, via configuration menu.
- 13A7.B supplied with colour camera with 1/4" sensor, minimum illuminance 1.0 lux, white LED for subject lighting and manual pan/tilt adjustment.
- 13A4.B with inputs/outputs for connection and control of an external camera, in configuration as video electronic unit.
- Possibility to connect up to 2 12TS.B, for a maximum of 8 buttons for direct calls.
- Power supply: Due Fili Plus Bus.
- Input for additional power supply (6923).
- Output for activation of electric lock (peak current $I_T > 1$ A for 10 ms followed by holding current $I_M = 200$ mA for as long as the lock control remains active).
- 2 outputs for activation of 2 relays 0170/001 operating auxiliary services.
- Input for door open sensor.
- Input for activation of lock by remote control.
- Removable terminal block for connection to system.

Technical data	13A4.B	13A7.B
Power supply from bus	voltage min. 21 Vdc	voltage min. 21 Vdc
Recording angle	horizontal	84°
	vertical	69°
Opening at 1 m	horizontal	1.8 m
	vertical	1.4 m
Current draw in stand-by	120 mA	120 mA
Max current draw in operation	470 mA	470 mA
Operating temperature	from -10° to +55° C	from -10° to +55° C
additional power supply	with 6923	with 6923

Option of using additional power supply 6923 where necessary (bus voltage at terminals 1 and 2 of electronic unit registering < 21 Vdc).

13F3.B and 13F5.B - Main characteristics

- Electronic unit with 8 call buttons arranged in 2 lines (4+4).
- Facility of increasing the number of call buttons by installing additional module 12TS.B (4 buttons in single line).
- Illuminated "Engaged - Please Wait" signal.
- Automatic configuration of indoor station addresses.
- Audio external unit with sound balance, internal volume and external volume adjustments provided by trimmers.
- 13F5.B supplied with colour camera with 1/4" sensor, minimum illuminance 1.0 lux, white LED for subject lighting and

manual pan/tilt adjustment.

- 13F3.B with inputs/outputs for connection and control of an external camera, in configuration as video electronic unit.
- Basic parameters configurable with the 8 buttons of the electronic unit; configuration of advanced parameters using programmer 950C or alternatively, the PC software application SaveProg.
- Power supply: Due Fili Plus Bus.
- Input for additional power supply (6923).
- Output for activation of electric lock (peak current $I_T > 1$ A for 10 ms followed by holding current $I_M = 200$ mA for as long as the lock control remains active).
- 2 outputs for activation of 2 relays 0170/001 operating auxiliary services.
- Input for door open sensor.
- Input for activation of lock by remote control.
- Removable terminal block for connection to system.

Technical data	13F3.B	13F5.B
Power supply from bus	voltage min. 21 Vdc	voltage min. 21 Vdc
Recording angle	horizontal	84°
	vertical	69°
Opening at 1 m	horizontal	1.8 m
	vertical	1.4 m
Current draw in stand-by	60 mA	60 mA
Max current draw in operation	450 mA	450 mA
Operating temperature	from -10° to +55° C	from -10° to +55° C
Additional power supply	with 6923	with 6923

Option of using additional power supply 6923 where necessary (bus voltage at terminals 1 and 2 of electronic unit registering < 21 Vdc).

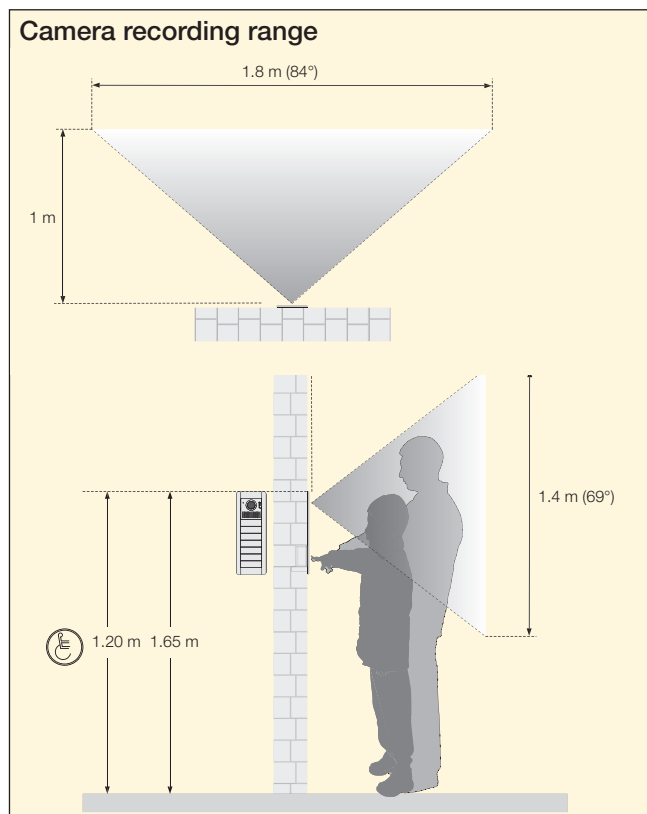

Steely entrance panels

Electronic units with alphanumeric keypad and display

▲ 13A7.B	Due Fili Plus electronic unit for Patavium and Steely colour audio/video entrance panel with alphanumeric keypad, display and electronic contacts list, 6400 indoor stations, with white LED backlighting, stainless steel buttons
▲ 13A4.B	Due Fili Plus electronic unit for Patavium and Steely audio entrance panel with alphanumeric keypad, display and electronic contacts list, 6400 indoor stations, option of connecting to a CCTV type external camera, white LED backlighting, stainless steel buttons



▲ 13A7.B
stainless steel buttons



▲ 13A4.B
stainless steel buttons

Electronic units with buttons

▲ 13F5.B	Due Fili Plus electronic unit for colour audio/video entrance panel with conventional buttons, colour camera, BUSY-WAIT indication, 8 buttons in 2 rows (4+4), with white LED backlighting
▲ 13F3.B	Due Fili Plus electronic unit for audio entrance panel with conventional buttons, BUSY-WAIT indication, 8 buttons in 2 rows (4+4), option of connecting to a CCTV type external camera, with white LED backlighting



▲ 13F5.B



▲ 13F3.B

Additional unit

▲ 12TS.B	Additional electronic unit with 4 buttons in 1 row, for electronic units for 1200, 1300, Patavium and Steely entrance panels
----------	--



▲ 12TS.B

Steely entrance panels

Steely series cover plates

Stainless steel audio/video cover plates with frame, for use in conjunction with electronic units and flush mounting boxes to make up entrance panels. The 2-module audio and audio/video cover plates can be extended both horizontally and vertically, combining them to the additional 2-module cover plates, using flush mounting boxes. The cover plates and boxes are supplied in 3 different heights: 2-, 3- and 4-module.

Regulatory compliance

EMC directive

Main characteristics

Cover plate in 4 mm thick 316L brushed stainless steel.

- IK08 protection rating against impact (cover plates with buttons), IK07 (cover plates for display and alphanumeric keypad) and protection degree IP54.
- 2 special steel screws for fixing the cover plate to the box.
- Buttons carried in transparent impact-resistant polycarbonate support.
- Zinc-plated steel frame.
- Buttons moulded from transparent polycarbonate with protective stainless steel cap.
- Dimensions of 2-module cover plate: 119.8x299.5x4 mm
- Dimensions of 2-module box: 99.9x270.2x60.6 mm
- Dimensions of 3-module cover plate: 119.8x414x4 mm
- Dimensions of 3-module box: 99.9x384.7x60.6 mm
- Dimensions of 4-module cover plate: 119.8x528.5x4 mm
- Dimensions of 4-module box: 99.9x499.2x60.6 mm

Installations

- A) Cover plate and frame.
- B) Electronic unit.
- C) Flush mounting box.
- D) Electronic unit terminal block.
- E) Brackets for box coupling.

Flush-mounted installation

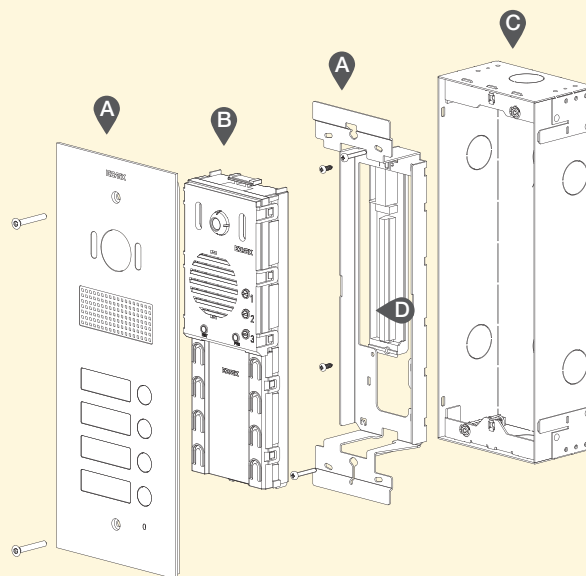

Flush mounting box coupling

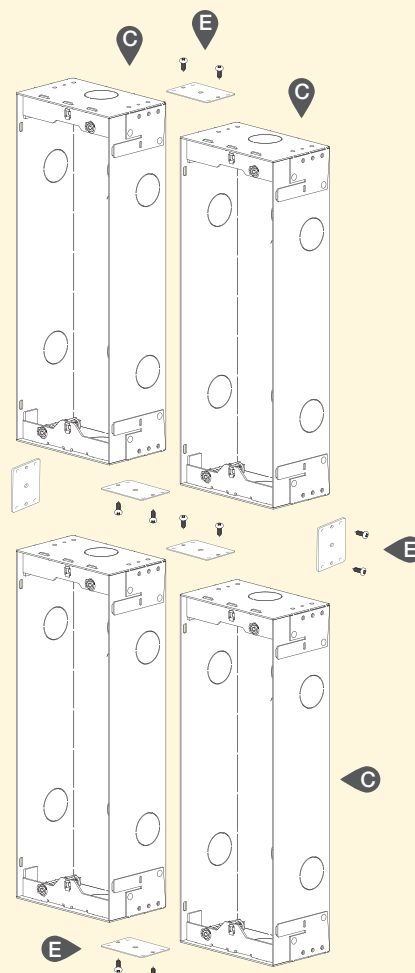

Steely entrance panels

2 modules audio-video cover plates

▲ 41521	2-module audio-video cover plate with 1 button, Steely, stainless steel
▲ 41522	As above, with 2 buttons
▲ 41523	As above, with 3 buttons
▲ 41524	As above, with 4 buttons
▲ 41541	2-module audio-video cover plate for Due Fili Plus electronic units with alphanumeric keypad, Steely, stainless steel



▲ 41521
stainless steel



▲ 41522
stainless steel



▲ 41523
stainless steel



▲ 41524
stainless steel

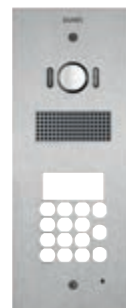

▲ 41541
stainless steel

2 modules audio cover plates

▲ 41501	2-module audio cover plate with 1 button, Steely, stainless steel
▲ 41502	As above, with 2 buttons
▲ 41503	As above, with 3 buttons
▲ 41504	As above, with 4 buttons
▲ 41540	2-module audio cover plate for Due Fili Plus electronic units with alphanumeric keypad, Steely, stainless steel

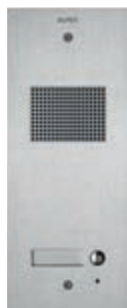

▲ 41501
stainless steel

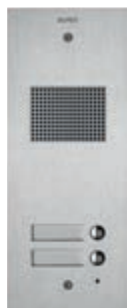

▲ 41502
stainless steel



▲ 41503
stainless steel



▲ 41504
stainless steel

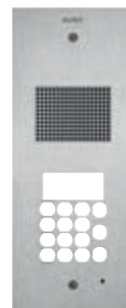

▲ 41540
stainless steel

2 modules additional cover plates

▲ 41542	2-module cover plate with 3 illuminated cards for 11+11+11 names, Steely, LED lighting, rear card extraction, stainless steel
▲ 41543	2-module additional cover plate with conventional 8 buttons, Steely, stainless steel



▲ 41542
stainless steel



▲ 41543
stainless steel

Steely entrance panels

3 and 4 modules audio-video cover plates

▲ 41526	3-module audio-video cover plate with 6 buttons, Steely, stainless steel
▲ 41528	As above, with 8 buttons
▲ 41530	4-module audio-video cover plate with 10 buttons, Steely, stainless steel
▲ 41532	As above, with 12 buttons



▲ 41526
stainless steel



▲ 41528
stainless steel



▲ 41530
stainless steel



▲ 41532
stainless steel

3 and 4 modules audio cover plates

▲ 41506	3-module audio cover plate with 6 buttons, Steely, stainless steel
▲ 41508	As above, with 8 buttons
▲ 41510	4-module audio cover plate with 10 buttons, Steely, stainless steel
▲ 41512	As above, with 12 buttons



▲ 41506
stainless steel



▲ 41508
stainless steel



▲ 41510
stainless steel



▲ 41512
stainless steel

Steely entrance panels

Flush mounting boxes

▲ 41592	Zinc-plated metal 2M flush mounting box for Patavium and Steely entrance panels
▲ 41593	Zinc-plated metal 3M flush mounting box for Patavium and Steely entrance panels
▲ 41594	Zinc-plated metal 4M flush mounting box for Patavium and Steely entrance panels



▲ 41592



▲ 41593



▲ 41594